

ENGINEERING DEPARTMENT	BY	APPROVED	DATE
	AS-BUILT		
REVISIONS			
CONSTRUCTION SURVEYOR		CONSTRUCTION RECORDS	
NAME		DATE STARTED:	
COMPANY		INSPECTOR:	
SIGNATURE		DATE COMPLETED:	
SURVEYOR: AGUIRRE & ASSOCIATES		BENCHMARK:	
K AVE. & 28TH ST. BRASS PLUG IN WEST CURB			
HORIZONTAL CONTROL: 2"IP & DISC. RCE 26112. PER ROS 14841			
BRASS DISC "LS 6000" IN CURB INLET PER ROS 17055			

BEGIN ALIGNMENT
 STA: 10+00.00
 OFF: 0.00'
 N: 1821230.52
 E: 6304513.42

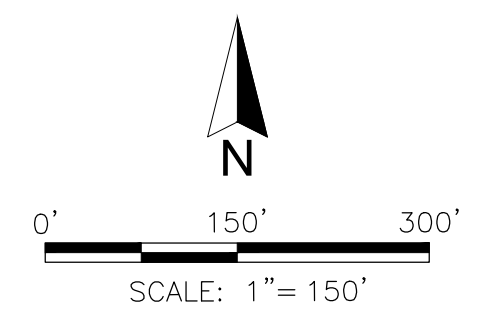
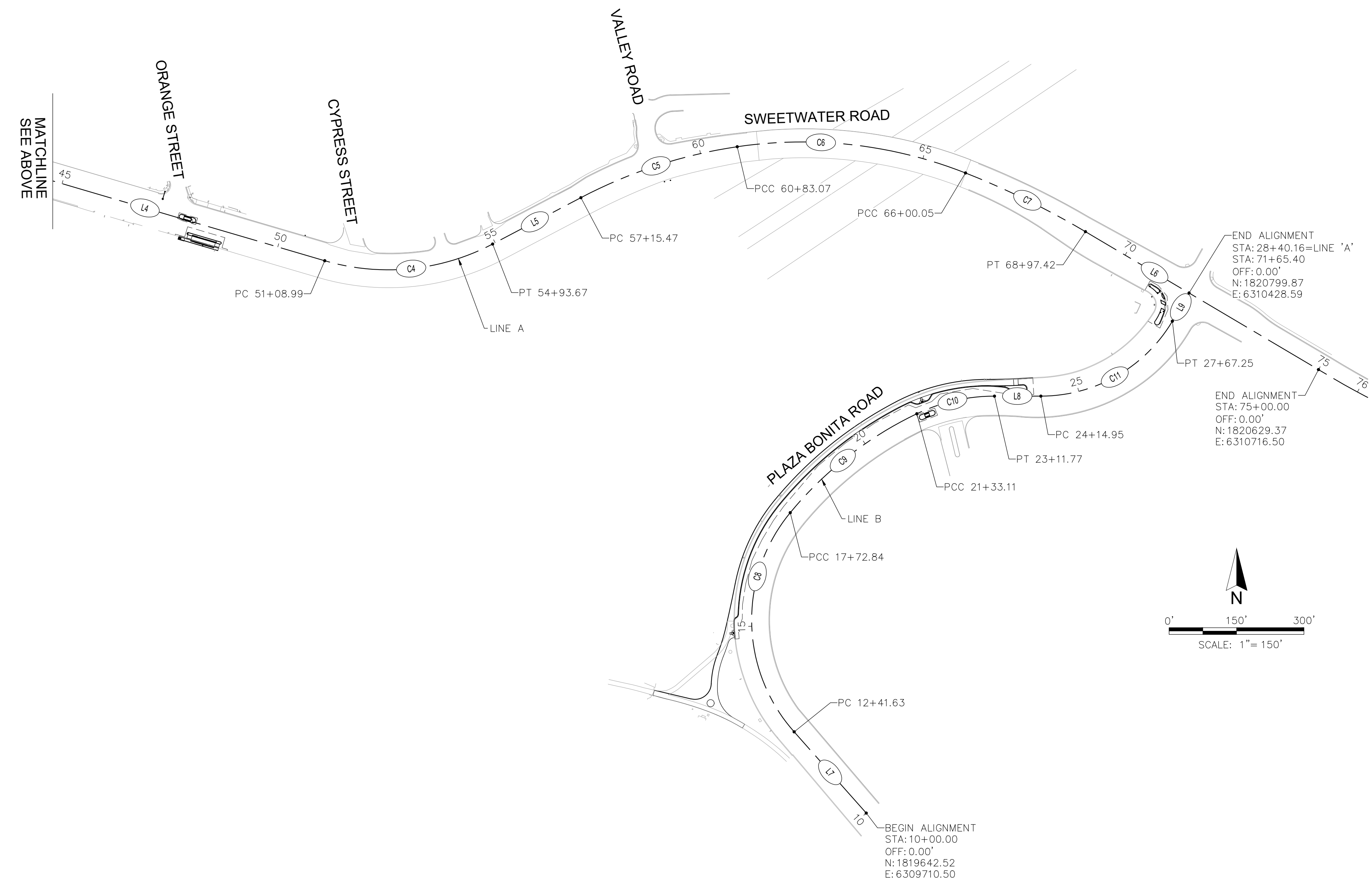
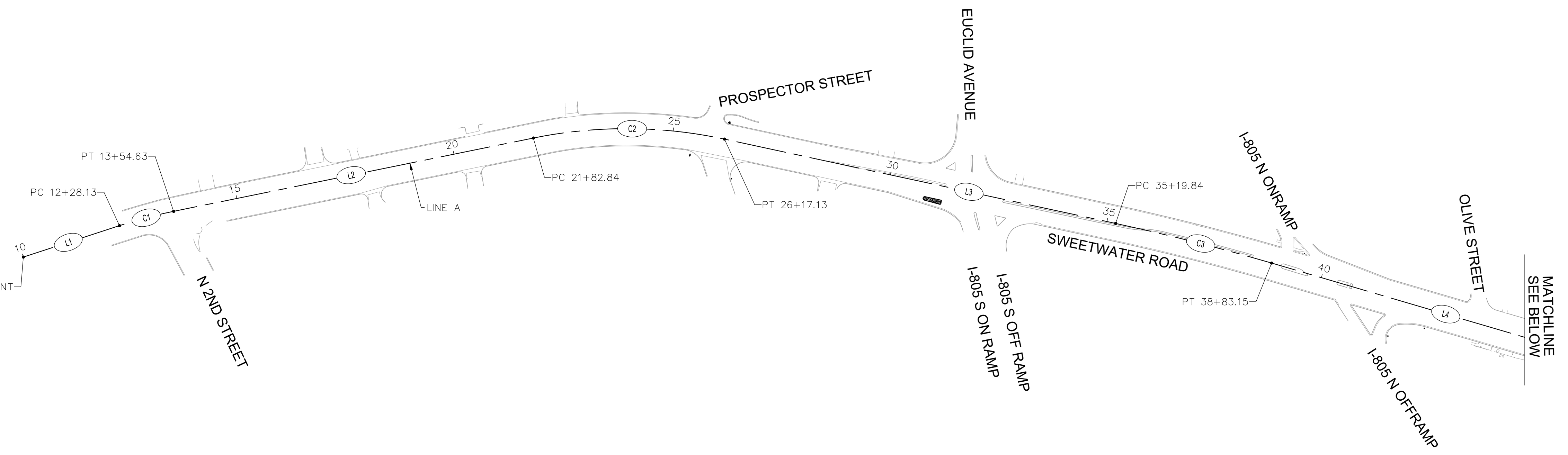

DECLARATION OF RESPONSIBLE CHARGE

I HEREBY DECLARE THAT I AM THE ENGINEER OF WORK FOR THIS PROJECT, THAT I HAVE EXERCISED RESPONSIBLE CHARGE OVER THE DESIGN OF THIS PROJECT AS DEFINED IN SECTION 6703 OF THE BUSINESS AND PROFESSIONAL CODE, AND THAT THE DESIGN IS CONSISTENT WITH CURRENT STANDARDS.

I UNDERSTAND THAT THE CHECK OF THESE PROJECT DRAWINGS AND SPECIFICATIONS BY THE CITY OF NATIONAL CITY IS CONFINED TO A REVIEW ONLY AND DOES NOT RELIEVE ME AS ENGINEER OF WORK OF MY RESPONSIBILITIES FOR THE PROJECT DESIGN.

Matthew B. Capuzzi
 MATTHEW B. CAPUZZI, 69815
 DATE: 05/25/2022



CALIFORNIA NATIONAL CITY 1337 INCORPORATED

PLANS FOR THE IMPROVEMENTS OF:

SWEETWATER ROAD BIKEWAY
 HORIZONTAL CONTROL

CITY OF NATIONAL CITY

Roberto Yano
 ROBERTO YANO, RCE# 56292
 DIRECTOR OF PUBLIC WORKS/CITY ENGINEER
 DATE: 5/25/2022

CIP NO. 19-20 HC-01

SHEET 4 OF 48 SHEETS XXXX-XX-D

100% IMPROVEMENT PLANS - CITY OF NATIONAL CITY - SWEETWATER ROAD BIKEWAY